



# Product Catalogue

2025

## Innovative Handrail Fittings

Uni-Fit provides a comprehensive range of handrail fittings and guardrail, offering a compliant & simple alternative for every fencing and handrail project. Uni-Fit fittings streamline installation with their unique multi-directional adjustment capabilities, allowing quick no-weld fitment onsite to suit any stair angle or ground configuration!

Our expanded product range ensures we have the right component for every handrail or guardrail application. Ideal for applications such as balustrades, stair rails, bike rails, fall/edge protection and much more! Supported by a 5 Year Warranty, the Uni-Fit range is engineered for durability, ease of use, and cost-effectiveness.

Uni-Fit is committed to maintaining large stock holdings across two main warehouses (Melbourne & Sydney) and our standard stock range is complemented by our cutting edge, automated manufacturing facility to ensure we have a solution for every application!



***Removing complexity from every handrail project with a range of innovative components for quick & compliant installation.***

### AUSTRALIAN STANDARDS COMPLIANT

The Uni-Fit range has been extensively tested to ensure compliance to all relevant Australia Standards! Our range can be configured to meet the requirements of AS1657-2018, AS1428.2 and AS1170.1 and our team can assist to ensure compliance with the relevant sections of BCA and DDA for your project! With a focus on ensuring compliant disabled access across Industrial, commercial & residential settings, make sure you reach out to our team today to discuss your project requirements!



# UNI-FIT MANUFACTURING

The Uni-Fit range of fittings is sourced from globally renowned manufacturers with a focus on stringent quality control and state-of-the-art production technologies! However, we complement the Uni-Fit components with our in-house steel pipe manufacturing capabilities allowing us to supply a solution for every application! By leveraging robotic manufacturing techniques and continuous process improvements, we deliver durable, cost-effective solutions that meet the evolving demands of our customers. We're continuously designing new products and developing smart and effective solutions that keep us at the forefront of the handrail industry



NSW Location

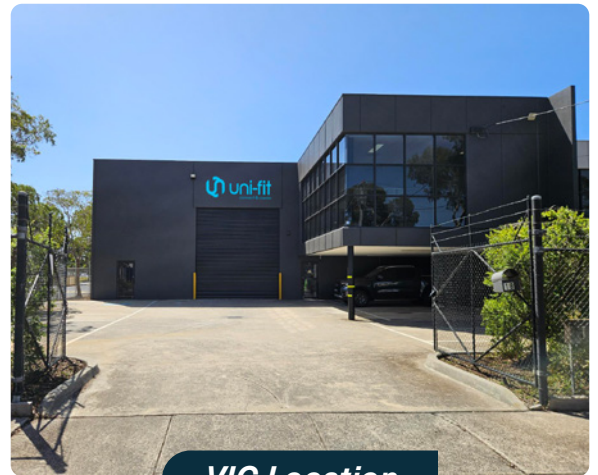

VIC Location

## Why Uni-Fit?

Uni-Fit is a trusted brand with over 30 Years experience in supplying quality fittings to the handrail industry. As a family owned brand, we offer reliable expertise and premium products that are easy to install, compliant with relevant Australian Standards and highly versatile. We service a comprehensive range of industries including Mezzanines & Raised Work Platforms, Industrial Handrails, Public Infrastructure, Parks and Gardens, Home Modifications for Disabled Access, Local Councils, Utilities, Fencing and much more!



## Visit us online

Stay up to date with the latest product innovations, industry news, and updates from **Uni-Fit**. Discover our full range of high-quality couplings and connectors. Visit us online today at [www.uni-fit.com.au](http://www.uni-fit.com.au).

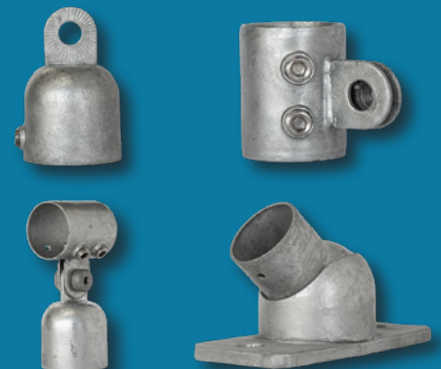

## Cup with Bolt

CODE	DESCRIPTION	SIZE
<b>UFCUP-25</b>	Cup with Bolt	25NB
<b>UFCUP-32</b>	Cup with Bolt	32NB
<b>UFCUP-40</b>	Cup with Bolt	40NB
<b>UFCUP-50</b>	Cup with Bolt	50NB



## One Way Ring

CODE	DESCRIPTION	SIZE
<b>UFR1-25</b>	One Way Ring	25NB
<b>UFR1-32</b>	One Way Ring	32NB
<b>UFR1-40</b>	One Way Ring	40NB
<b>UFR1-50</b>	One Way Ring	50NB



## Two Way Fixed Ring

CODE	DESCRIPTION	SIZE
<b>UFR2-32</b>	Two Fixed Way Ring	32NB
<b>UFR2-40</b>	Two Fixed Way Ring	40NB
<b>UFR2-50</b>	Two Fixed Way Ring	50NB



## Two Way Split Ring

CODE	DESCRIPTION	SIZE
<b>UFSR2P-40</b>	Two Way Split Ring (2 Piece) - 40mm	40NB



## Rail Plate

CODE	DESCRIPTION	SIZE
<b>UFPR</b>	Rail Plate	Suits 32/40/50NB



## Wall Bracket

CODE	DESCRIPTION	SIZE
UFWB	Wall Bracket	Suits 32/40/50NB

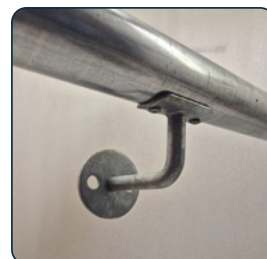

## Base Plate with Welded Cup

CODE	DESCRIPTION	SIZE
UFBP-32	Base Plate with Welded Cup	32NB
UFBP-40	Base Plate with Welded Cup	40NB
UFBP-50	Base Plate with Welded Cup	50NB

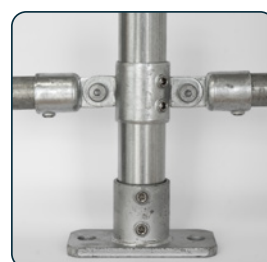

## Side Mount Base Plate

CODE	DESCRIPTION	SIZE
UFSBP-40	Side Mount Base Plate	40NB



## Adjustable Base Plate

CODE	DESCRIPTION	SIZE
UFABP-40	Adjustable Base Plate	40NB



## Straight Joiner

CODE	DESCRIPTION	SIZE
UF 180-25	Straight Joiner	25NB
UF 180-32	Straight Joiner	32NB
UF 180-40	Straight Joiner	40NB
UF 180-50	Straight Joiner	50NB





## 90 ° Elbow Joiner

CODE	DESCRIPTION	SIZE
UF J90-25	90 ° Elbow Joiner	25NB
UF J90-32	90 ° Elbow Joiner	32NB
UF J90-40	90 ° Elbow Joiner	40NB
UF J90-50	90 ° Elbow Joiner	50NB



## Straight Joiner - Series 3

CODE	DESCRIPTION	SIZE
S3UFJ180IN-32	Straight Joiner - Series 3	32NB
S3UFJ180IN-40	Straight Joiner - Series 3	40NB



## Kick Plate & Bracket

CODE	DESCRIPTION	SIZE
UFFKP-30	Folded Kick Plate	100mm H x 3000mm L
UFKBP	Kick Plate Bracket	100 x 100mm
UFKJP-10	Kick Plate Joining Bracket	100 x 100mm



## Round Metal Cap

CODE	DESCRIPTION	SIZE
UFMCAP-25	Round Metal Cap	25NB
UFMCAP-32	Round Metal Cap	32NB
UFMCAP-40	Round Metal Cap	40NB
UFMCAP-50	Round Metal Cap	50NB



## Round Plastic Cap Black

CODE	DESCRIPTION	SIZE
UFPCAP-25	Round Plastic Cap Black	25NB
UFPCAP-32	Round Plastic Cap Black	32NB
UFPCAP-40	Round Plastic Cap Black	40NB
UFPCAP-50	Round Plastic Cap Black	50NB



## Galvanised Pipe

CODE	DESCRIPTION	SIZE
<b>GP25M-6500</b>	Galvanised Pipe -25NB	6500mm
<b>GP32M-6500</b>	Galvanised Pipe -32NB	6500mm
<b>GP40M-6500</b>	Galvanised Pipe -40NB	6500mm
<b>GP50M-6500</b>	Galvanised Pipe -50NB	6500mm



## 25NB Rail Bends 1500 x 300mm

CODE	DESCRIPTION	SIZE
<b>RB1530-34</b>	25NB Rail Bends - 34 °	1500 x 300mm
<b>RB1530-36</b>	25NB Rail Bends - 36 °	1500 x 300mm
<b>RB1530-38</b>	25NB Rail Bends - 38 °	1500 x 300mm

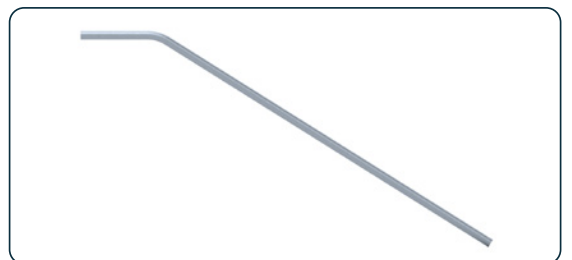

## 25NB Rail Bends 300 x 300mm

CODE	DESCRIPTION	SIZE
<b>RB30-34</b>	25NB Rail Bends - 34 °	300 x 300mm
<b>RB30-36</b>	25NB Rail Bends - 36 °	300 x 300mm
<b>RB30-38</b>	25NB Rail Bends - 38 °	300 x 300mm



## 32NB Rail Bends 1500 x 375mm

CODE	DESCRIPTION	SIZE
<b>RB1537-34</b>	32NB Rail Bends - 34 °	1500 x 375mm
<b>RB1537-36</b>	32NB Rail Bends - 36 °	1500 x 375mm
<b>RB1537-38</b>	32NB Rail Bends - 38 °	1500 x 375mm

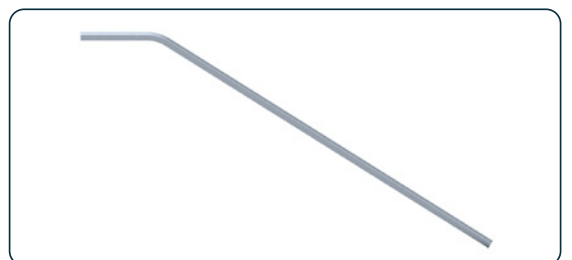

## 32NB Rail Bends 375 x 375mm

CODE	DESCRIPTION	SIZE
<b>RB37-34</b>	32NB Rail Bends - 34 °	375 x 375mm
<b>RB37-36</b>	32NB Rail Bends - 36 °	375 x 375mm
<b>RB37-38</b>	32NB Rail Bends - 38 °	375 x 375mm

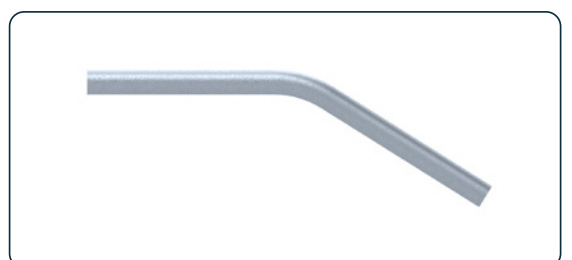

## Rail Bends - 90°

CODE	DESCRIPTION	SIZE
<b>RB30-90</b>	25NB Rail Bends - 90 °	300 x 300mm
<b>RB37-90</b>	32NB Rail Bends - 90 °	375 x 375mm



## Closure Bends - 90°

CODE	DESCRIPTION	SIZE
<b>CB35-90</b>	32NB Closure Bends - 90 °	350 x 275mm



## Top Closure Bends

CODE	DESCRIPTION	SIZE
<b>TCB35-34</b>	32NB Top Closure Bends - 34 °	350 x 284mm
<b>TCB35-36</b>	32NB Top Closure Bends - 36 °	350 x 284mm
<b>TCB35-38</b>	32NB Top Closure Bends - 38 °	350 x 284mm

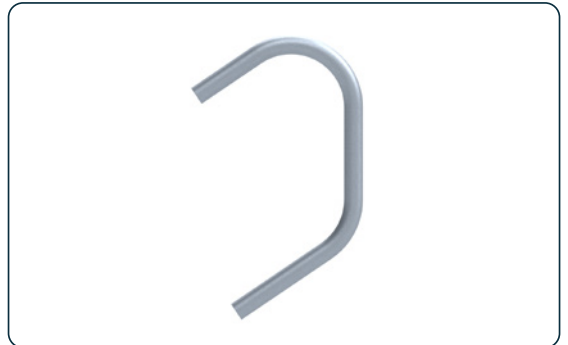

## Bottom Closure Bends

CODE	DESCRIPTION	SIZE
<b>BCB35-34</b>	32NB Bottom Closure Bends - 34 °	350 x 285mm
<b>BCB35-36</b>	32NB Bottom Closure Bends - 36 °	350 x 285mm
<b>BCB35-38</b>	32NB Bottom Closure Bends - 38 °	350 x 285mm

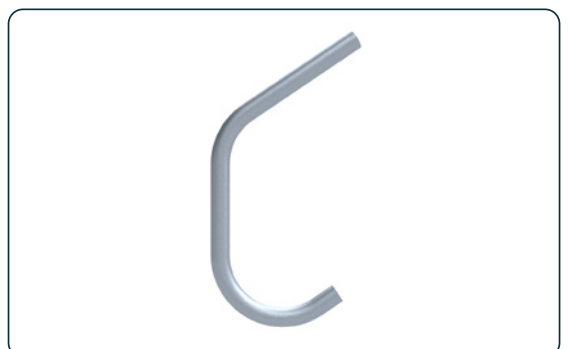



## Safety Rail Bend

CODE	DESCRIPTION	SIZE
<b>SRB32-2</b>	Safety Rail Bend - 32NB	2000mm L
<b>SRB40-2</b>	Safety Rail Bend - 40NB	2000mm L

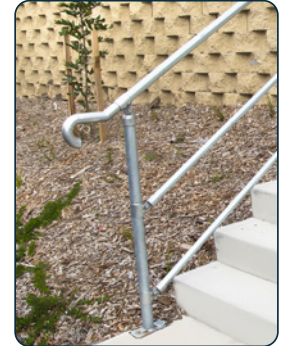

## Vertical Bar Pedestrian Barrier

CODE	DESCRIPTION	SIZE
<b>VBPB-2</b>	Vertical Bar Pedestrian Barrier	2000 x 1012mm

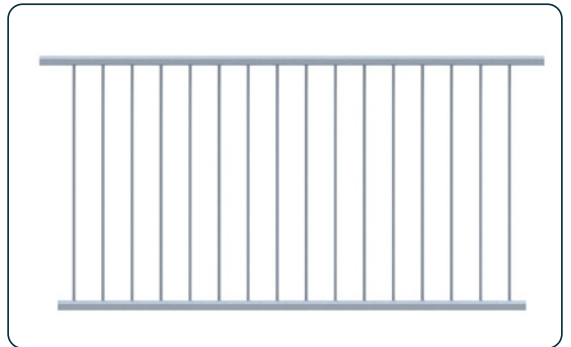

## Vertical Bar Barrier Post

CODE	DESCRIPTION	SIZE
<b>VBEP-40</b>	Vertical Bar Barrier End Post - 40NB	1100mm H
<b>VBMP-40</b>	Vertical Bar Barrier Mid Post - 40NB	1100mm H

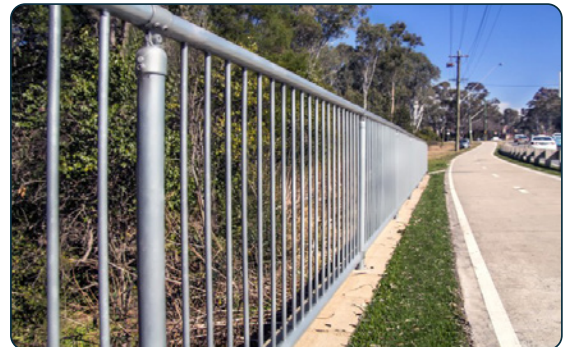

## Vertical Bar Barrier Bike Post

CODE	DESCRIPTION	SIZE
<b>VBEBP-40</b>	Vertical Bar Barrier End Bike Post - 40NB	1400mm H
<b>VBMBP-40</b>	Vertical Bar Barrier Mid Bike Post - 40NB	1400mm H



## Guard-PRO

CODE	DESCRIPTION	SIZE
<b>GPPS-750</b>	Single Guard-PRO Post - Galvanised	750mm
<b>GPPD-1000</b>	Double Guard-PRO Post - Galvanised	1000mm
<b>GPR-1318</b>	Guard-PRO Rail - Galvanised	1318mm L
<b>GPR-2318</b>	Guard-PRO Rail - Galvanised	2318mm L
<b>GPR-3318</b>	Guard-PRO Rail - Galvanised	3318mm L
<b>GPR-4318</b>	Guard-PRO Rail - Galvanised	4318mm L



**Customisable! Curved rails available to suit your requirements.**

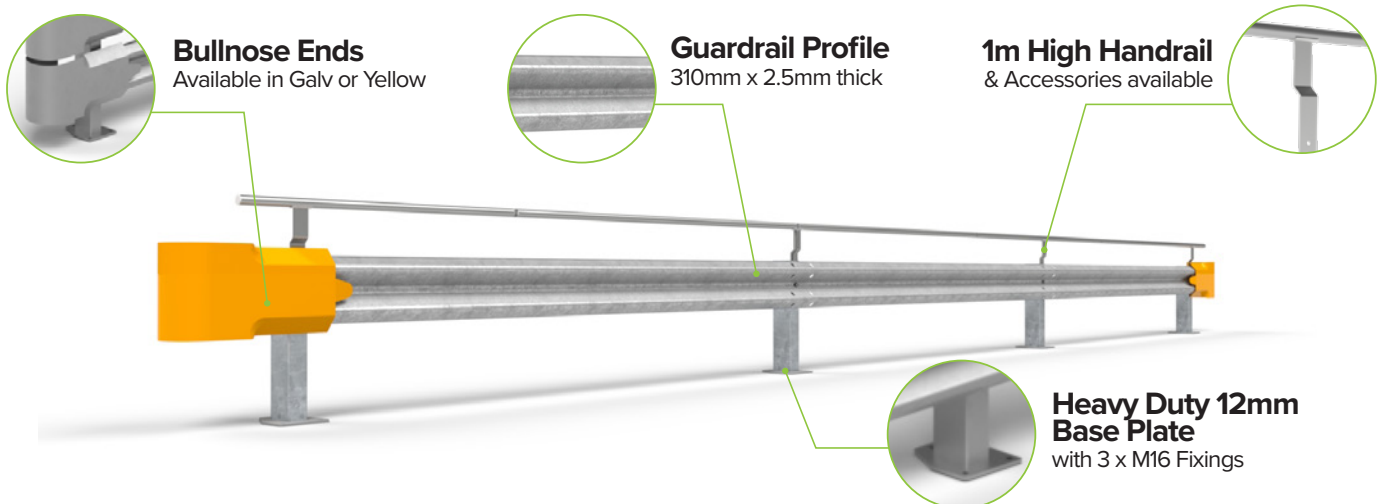

## Yellow Powder Coat Finish Available

In addition to being customisable in size, our barriers can also be tailored to match your aesthetic preferences. We offer a yellow powder coat finish option, adding visibility and enhancing safety in your workplace.



# Guard-PRO Range - Accessories

CODE	DESCRIPTION
GPUC	Guard-PRO Universal Corner
GPBE-G	Guard-PRO Bullnose End - Galvanised
GPBE-P	Guard-PRO Bullnose End - Powdercoat Yellow
GPEC	Guard-PRO Rail End Cap
GPHB	Guard-PRO Handrail Bracket - Galvanised
GPHP	Guard-PRO Handrail Pipe - Galvanised
GPFM16-50	Guard-PRO Post Fixings - Bolt/Nut/Washer M16x50
GPFM16-32	Guard-PRO Rail Fixings - Bolt/Nut/Washer M16x32
GPAM16-125	Guard-PRO Anchor (3 per Post) M16x125



## Guard-PRO - Accessories



**Guard-PRO**  
Bullnose End



**Guard-PRO**  
Universal Corner



**Guard-PRO**  
Handrail Bracket







# Uni-Fit

 1800 868 544

 [sales@uni-fit.com.au](mailto:sales@uni-fit.com.au)

 [www.uni-fit.com.au](http://www.uni-fit.com.au)

---

 NSW Office: 3 Kelham Place  
Glendenning NSW 2761

 VIC Office: 18 Centofanti Place  
Thomastown VIC 3074