

SLIDING TRACK		GUIDES	
Track Series 120	2	Guide Block Nylon	6
Track Series 200	2	Guide Rollers	6
Track Series 450	2	Timber Guide Rollers	6
Track Series 650	2	Plough Guide	6
		Single Wall Guide	6
		Double Wall Guide	6
HANGERS		GROUND STAYS	
2 Wheel Hangers	2	Ground Stay Nylon Roller	6
4 Wheel Hangers	2	Ground Stay Steel Roller	6
		Ground Stay Surface Mount	6
		Shoe Guide	6
		Nylon Saw Cut Guide	6
SLIDING DOOR HARDWARE		ACCESSORIES	
Top Plate Assembly	3	Door Stop with Rubber Buffer	7
		Drop Bolt	7
		Flush Pull	7
		Handle	7
		Bow Handle	7
SIDE FIX BRACKETS			
Single Track	3		
Single Track - Offset	3		
Double Track	3		
OVERHEAD BRACKETS			
Standard	4		
Single Track - Bolt	4		
Double Track - Bolt On/ Weld On	4		
Angle Brackets	4		
End Clips	5		
Bolt & Nut Sets	5		
Track Stop Buffer	5		
CHANNEL			
D93 Channel 16x16x1.2	5		
D97 Channel 38x27x3	5		
D100 Channel 27x27x3	5		

* For terms & conditions of sale please read the last page of this catalogue

PIPE DIMENSIONS

NOMINAL BORE (ID) (NB)		OUTSIDE DIAMETER	
IMPERIAL	METRIC	IMPERIAL	METRIC
1/2 "	15 mm	27/32 " (0.844")	21.3 mm
3/4 "	20 mm	1 1/16 " (1.062")	26.9 mm
1 "	25 mm	1 11/32 " (1.343")	33.7 mm
1 1/4 "	32 mm	1 11/16 " (1.687")	42.4 mm
1 1/2 "	40 mm	1 29/32 " (1.906")	48.3 mm
2 "	50 mm	2 3/8 " (2.375")	60.3 mm
2 1/2 "	65 mm	3 " (3.000")	76.1 mm
3 "	80 mm	3 1/2 " (3.500")	88.9 mm
3 1/2 "	90 mm	4 " (4.000")	101.6 mm
4 "	100 mm	4 1/2 " (4.500")	114.3 mm
5 "	125 mm	5 " (5.5")	139.7 mm
6 "	150 mm	6 " (6.5")	165.1 mm

Unless otherwise specified all DOWNEE RMD component sizes relate to nominal bore pipe dimensions (NB)

TRACK - Bracket Spacing 600mm - Galvabond



CODE	SERIES	CAPACITY	GAUGE	LENGTH	PACK	KG
DT120-61-BD	120	120	1.0	6100	60	0.88/m
DT120-76-BD	120	120	1.0	7620	60	0.88/m
DT200-61-BD	200	200	1.2	6100	20	1.27/m
DT200-76-BD	200	200	1.2	7620	20	1.27/m
DT450-61-BD	450	450	1.5	6100	20	2.5/m
DT450-76-BD	450	450	1.5	7620	20	2.5/m
DT650-30-BD	650	650	2.5	3000	20	4.74/m
DT650-40-BD	650	650	2.5	4000	20	4.74/m
DT650-60-BD	650	650	2.5	6000	20	4.74/m

- Non stock track lengths by negotiation.

HANGERS - Zinc & Gold Passivated



Two hangers required per door

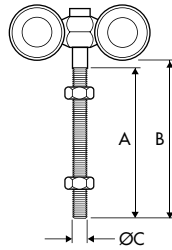

CODE	SERIES	CAPACITY	BOLT LENGTH	WHEEL	CTN	A	B	C	KG/CTN
2 WHEEL HANGERS									
DT120HS2100	120	80	100	STEEL	100	65	72	3/8"	11.0
DT120HS2120	120	80	120	STEEL	100	85	92	3/8"	13.8
DT120HN2100	120	80	100	NYLON	100	65	72	3/8"	8.7
DT120HN2120	120	80	120	NYLON	100	85	92	3/8"	11.5
DT200HS2100	200	120	100	STEEL	75	65	70	3/8"	10.5
DT200HS2120	200	120	120	STEEL	75	85	90	3/8"	12.5
DT200HN2100	200	120	100	NYLON	75	65	70	3/8"	8.0
DT200HN2120	200	120	120	NYLON	75	85	90	3/8"	10.0
DT450HS2120	450	250	120	STEEL	30	120	125	M12	15.0
DT450HN2120	450	250	120	NYLON	30	120	125	M12	12.0

- Two hangers required per door.



Two hangers required per door

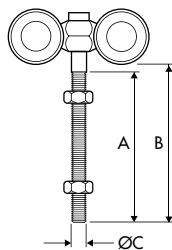

4 WHEEL HANGERS									
DT120HS4100	120	120	100	STEEL	50	65	72	3/8"	13.7
DT120HS4120	120	120	120	STEEL	50	85	92	3/8"	15.0
DT120HN4100	120	120	100	NYLON	50	65	72	3/8"	13.7
DT120HN4120	120	120	120	NYLON	50	85	92	3/8"	16.0
DT200HS4100	200	200	100	STEEL	50	65	70	3/8"	14.5
DT200HS4120	200	200	120	STEEL	50	85	90	3/8"	16.0
DT200HN4100	200	200	100	NYLON	50	65	70	3/8"	11.0
DT200HN4120	200	200	120	NYLON	50	85	90	3/8"	15.0
DT450HS4120	450	450	120	STEEL	20	120	125	M12	20.0
DT450HN4120	450	450	120	NYLON	20	120	125	M12	16.5
DT650HLS	650	650	120	STEEL	20	145	165	M16	22.0

- Two hangers required per door.

TOP PLATE ASSEMBLY - Zinc & Gold Passivated

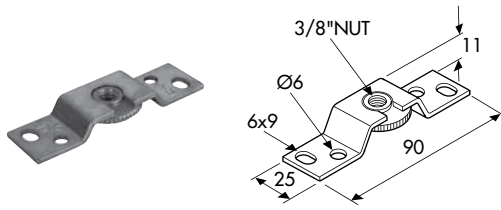

CODE	SERIES	CAPACITY	CTN	WEIGHT
DT120-200TP	120-200	200KG	100	6

- Use for attaching and adjusting timber doors.

SIDE FIX BRACKETS - 600mm Bracket Spacing - Zinc & Gold Passivated

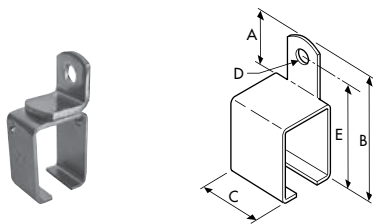

CODE	SERIES	TYPE	CTN	A	B	C	D	E	KG/CTN
SINGLE TRACK									
DT120-1	120	STANDARD	100	28	70	42	Ø7	57	10.0
DT120-1L	120	END/LEFT	100	-	-	-	-	-	10.0
DT120-1R	120	END/RIGHT	100	-	-	-	-	-	10.0
DT200-1	120	STANDARD	75	35	90	32	Ø12	68	14.2
DT450-650/1	450&650	STANDARD	20	43	128	50	Ø13.5	106	10.8

CODE	SERIES	TYPE	CTN	A	B	C	D	E	F	G	H	KG/CTN
SINGLE TRACK - OFFSET												
DT120-1A	120	STANDARD 25 OFFSET	100	65	110	60	Ø8	8X18	30	59	28	12.6
DT120-1AL	120	END/LEFT 25 OFFSET	100	-	-	-	-	-	-	-	-	12.6
DT120-1AR	120	END/RIGHT 25 OFFSET	100	-	-	-	-	-	-	-	-	12.6
DT200-1A	200	STANDARD 25 OFFSET	40	70	124	69	Ø10.5	Ø10.5	32	73	30	10.8
DT200-1B	200	STANDARD 35 OFFSET	40	-	-	-	-	-	-	-	-	10.8

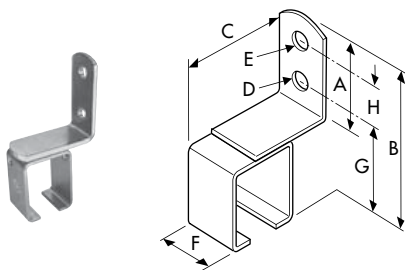

- Fits in pan of cladding.

CODE	SERIES	TYPE	CTN	A	B	C	D	E	F	G	H	KG/CTN
DOUBLE TRACK												
DT200-56	200	STANDARD 65 CENTRES	20	66	22	131	70	48	Ø10.5	82	30	9.0

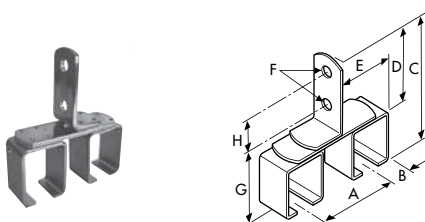

- Fits behind gutter in pan of cladding.

OVERHEAD BRACKETS - 600mm Bracket Spacing - Zinc & Gold Passivated

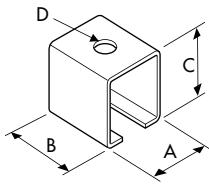

CODE	SUIT SERIES	TYPE	CTN	A	B	C	D	KG/CTN
SINGLE TRACK - BOLT ON/WELD ON								
DT120-2	120	STANDARD	100	36	42	42	Ø10	10.0
DT120-2C	120	END BRACKET	100	-	-	-	-	10.0
DT200-2	200	STANDARD	100	44	32	56	10SQ	10.0
DT450-650/2	450 & 650	STANDARD	30	66	50	84	14SQ	10.8

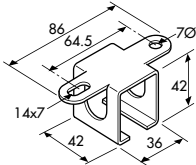

CODE	SUIT SERIES	TYPE	CTN	KG/CTN
SINGLE TRACK - BOLT ON				
DT120-3	120	STANDARD	100	10.0
DT120-3C	120	END BRACKET	100	10.0

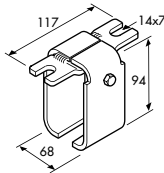

SINGLE TRACK - BOLT ON				
DT450-650/4	450 & 650	STANDARD 2 PART	20	15.2

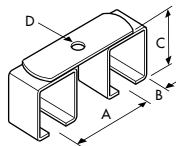

CODE	SUIT SERIES	TYPE	CTN	A	B	C	D	KG/CTN
DOUBLE TRACK - BOLT ON/WELD ON								
DT200-6A	200	STANDARD 65 CENTRES	30	66	22	61	Ø10.5	10.5
DT200-6B	200	STANDARD 75 CENTRES	30	76	22	61	Ø10.5	10.5

ANGLE BRACKETS - 600mm Bracket Spacing - Zinc & Gold Passivated

CODE	SUIT SERIES	TYPE	CTN	A	B	C	D	E	F	KG/CTN
DOUBLE										
DT120-5A	120	DOUBLE	40	114	76	86X8	Ø11.5	80	26	10.8
DT450-650/5A	450 & 650	DOUBLE	20	210	120	158X14	Ø11	60	40	11.4

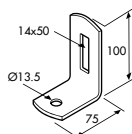
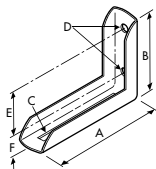

CODE	SUIT SERIES	TYPE	CTN	KG/CTN
SINGLE				
DT450650/SAB	450 & 650	SINGLE	50	17.0

END CLIPS - Galvabond



CODE	SUIT SERIES	CTN	KG/CTN
DT200EC	200	200	4.0
DT450-650EC	450 & 650	100	6.0

- Attaches to each end of track to eliminate track movement.
- Note: 120 Series Track requires no end clip because track movement is eliminated by an integral part of left or right hand end brackets

BOLT & NUT SETS - Zinc Plated



CODE	SUIT SERIES	CTN	KG/CTN
DT120BS	120	100	2.5
DT200BS	200	100	3.0
DT450-650/BS	450 & 650	200	16.0

TRACK STOP BUFFER - Zinc & Gold Passivated

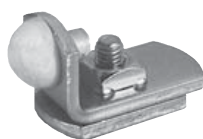

CODE	SUIT SERIES	CTN	KG/CTN
DT120-200TS	120 & 200	100	10.0
DT450-650TS	450 & 650	100	11.0

- Internally attached to track as an adjustable door stop.

CHANNEL - Galvabond



CODE	SUIT SERIES	LENGTH	PACK
D93 CHANNEL - 16x16x1.2 - 0.41KG/METRE			
DTD93-09	120	900	5.0
DTD93-12	120	1200	5.0
DTD93-15	120	1500	5.0
DTD93-18	120	1800	5.0

- Use with D102N Guide Block



# D97 CHANNEL - 38x27x3 - 2.13KG/METRE			
DTD97-20	200-650	2000	5.0
DTD97-30	200-650	3000	5.0
# D100 CHANNEL - 27x27x3 - 1.6KG/METRE			
DTD100-20	200-650	2000	5.0
DTD100-30	200-650	3000	5.0

- # Includes concrete lugs and couplers

GUIDES

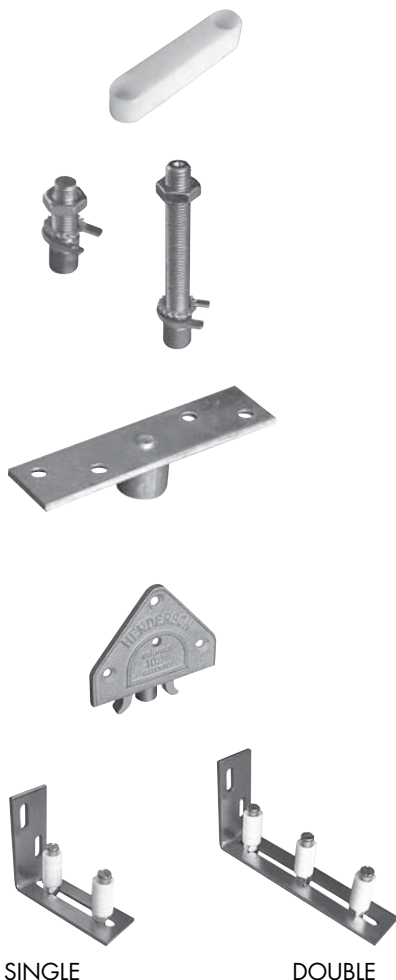

CODE	SUIT SERIES	CTN	KG/CTN
GUIDE BLOCK - NYLON			
DTD102N	120	20	0.1
• Use with D93 Channel			
GUIDE ROLLER - 30 BOLT LENGTH			
DTD104P	200-650	30	4.2
GUIDE ROLLER - 95 BOLT LENGTH			
DTD104PL	200-650	30	6.9
• Use with angle and channel section door frames			
TIMBER GUIDE ROLLER			
DTD106R	200-650	10	0.9
• For bottom fixing to timber doors			
PLOUGH GUIDE - HEAVY DUTY - 70 HOLES			
DTD102	200-650	10	5.0
• Use for side fixing			
SINGLE WALL GUIDE - 70 MAX DOOR WIDTH - 100 HOLES			
DTD31S	200-650	30	18.3
DOUBLE WALL GUIDE - 70 MAX DOOR WIDTH - 100 HOLES			
DTD31D	200-650	20	17.0

GROUND STAYS

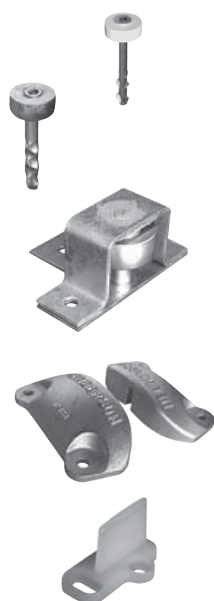

CODE	SUIT SERIES	CTN	KG/CTN
GROUND STAY NYLON ROLLER - 50Ø ROLLER - 100 BOLT			
DTD126	120-650	10	8.3
GROUND STAY STEEL ROLLER - 62Ø ROLLER - 140 BOLT			
D126H	200-650	20	18.0
GROUND STAY ROLLER SURFACE MOUNT - 61Ø ROLLER - 13 HOLES			
DTD126HDA	200-650	5	7.7
SHOE GUIDE - 50MM MAX. DOOR - 14Ø BOLT HOLES			
DTD128	200-650	5	6.3
• For Bi-parting doors. Includes centre stop			
NYLON SAW CUT GUIDE - 30x20x3 BLADE			
DTD101N	120	10	0.1
• Use for timber doors. Use two guides for steel doors			

ACCESSORIES



CODE	SUIT SERIES	CTN	KG/CTN
DOOR STOP WITH RUBBER BUFFER - 150 BOLT HOLES			
DTD109	120-650	10	10.2

- Single wall or ground stop



DROP BOLT - 310 BOLT LENGTH			
B13L	120-650	40	18.0



DROP BOLT - 400 BOLT LENGTH			
B15L	120-650	40	24.0



FLUSH PULL - 13x60x20 ALUMINIUM			
DTD414	120-650	30	3.3



HANDLE - 44x125x39 - POLYMER BLACK			
LLHBG	120-650	20	1.1

- Corner fix. 4 screws supplied



BOW HANDLE - 260x57 - IRON			
DTD464	120-650	10	8.7